

# PRIME ESTATES

INDEPENDENT ESTATE AGENTS

Goldstar Way, Kitts Green, Birmingham, West Midlands, B33 0YP

£140,000





**£140,000**

**Goldstar Way, Kitts Green,  
Birmingham, West Midlands, B33  
0YP**

- Mid Terrace House
- Modern Style Property
- Ideal First Time/Investment Property
- One Bedroom
- Open Plan Lounge & Kitchen Area
- Driveway
- First floor Bathroom
- No Upward Chain
- Rear Garden
- Energy Performance Certificate C

## EPC Rating

Current: C  
Potential: B

## Council tax band

Band = A

\* MID TERRACE HOUSE \* ONE  
BEDROOM \* MODERN STYLE  
PROPERTY \* NO UPWARD CHAIN!!  
ONLINE TOUR AVAILABLE NOW!!

ARE YOU FIRST TIME BUYER OR  
INVESTOR? THIS MODERN STYLE  
PROPERTY IS THE ANSWER...  
CALL OUR YARDLEY OFFICE ON 0121-  
783-3422 TO ARRANGE A VIEWING.  
The property is accessed via a  
DRIVEWAY providing parking for your  
vehicle and leading to an entrance  
door. The accommodation comprises  
of:- entrance hallway, OPEN PLAN  
LOUNGE & KITCHEN and rear garden  
to the ground floor. To the first floor  
there is ONE BEDROOM and a  
BATHROOM.  
The property benefits from central  
heating and double glazing both  
where specified and is offered with NO  
UPWARD CHAIN!  
Energy Performance Rating C

### APPROACH

The property is accessed via a dropped  
kerb and leading to:

### Driveway

A driveway providing parking for your  
vehicle with open borders to each side  
and leading to:-

### Entrance Hallway

Storage cupboard. Internal Door  
leading into the open plan lounge &  
kitchen.

### Open Plan Lounge & Kitchen Area 20'10" x 10'9" (6.35m x 3.28m)

Double glazed window to the front.  
Stairs leading to the first floor landing.  
radiator. Kitchen area comprises of a  
range of wall and base units with work  
surfaces over incorporating a sink and  
drainer unit with mixer tap over.  
Electric cooker point. Part tiling to the  
walls. Double glazed sliding doors to  
the rear allowing access to the rear  
garden.

### FIRST FLOOR

### Landing

Ceiling loft hatch. Double glazed  
window to the front. Storage  
Cupboard. Doors leading to first floor  
accommodation:-

### Bedroom

11'10" x 10'8" (3.61m x 3.25m)

Double glazed window to the rear and  
radiator.

Bathroom

Suite comprises of a panelled bath unit with an electric shower over, pedestal wash basin and low flush W.C. Part tiling to the walls. Double glazed window to the front.

OUTSIDE

Rear Garden

Timber fenced perimeter. The rear garden comprises of artificial lawn and shrubbery. Timber storage shed.

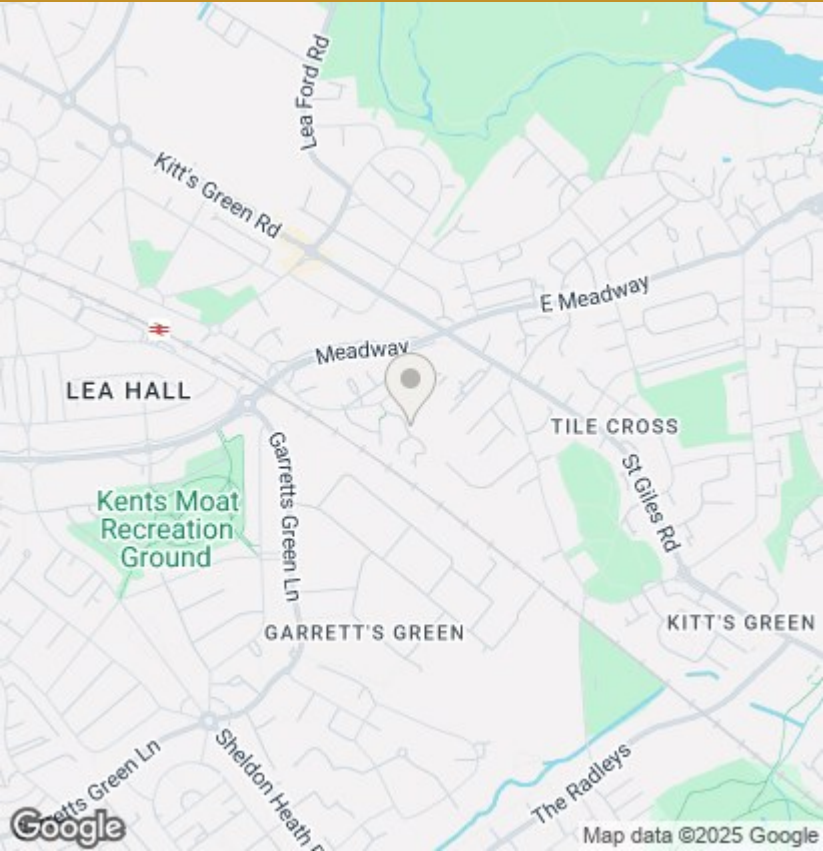
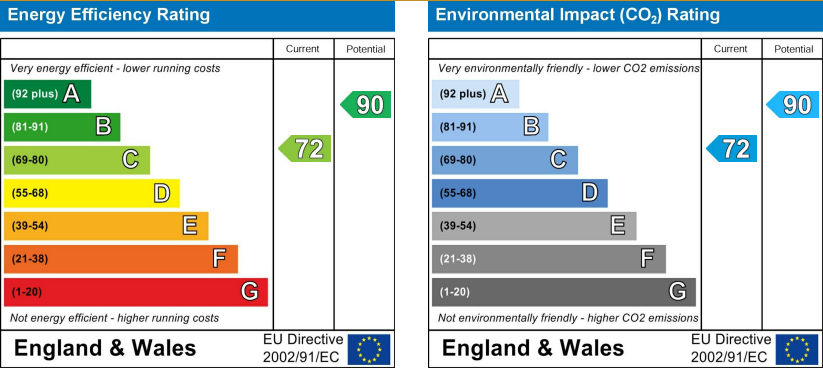

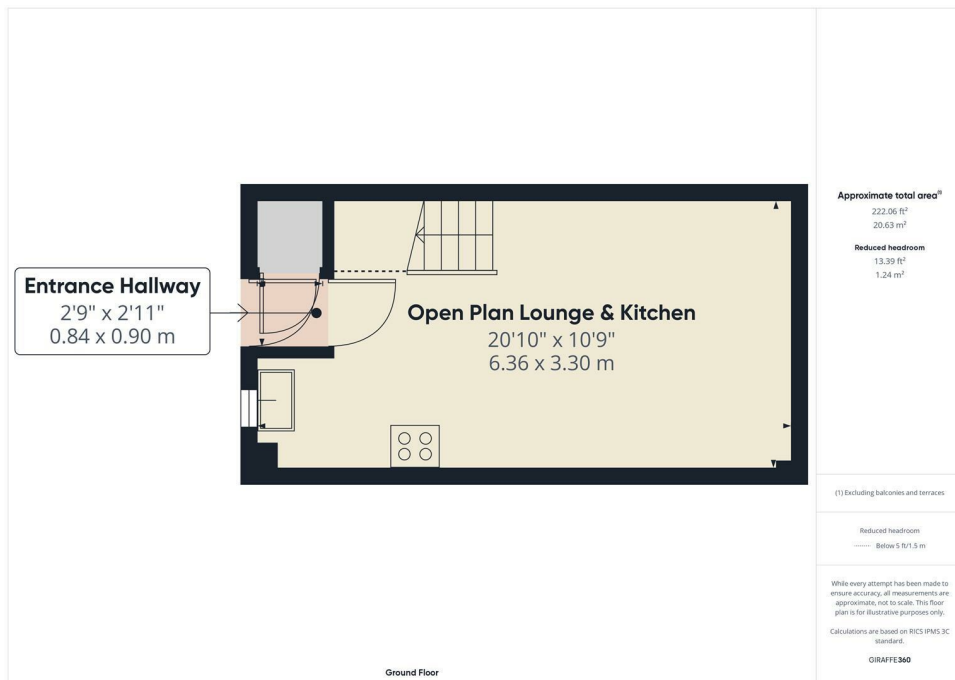
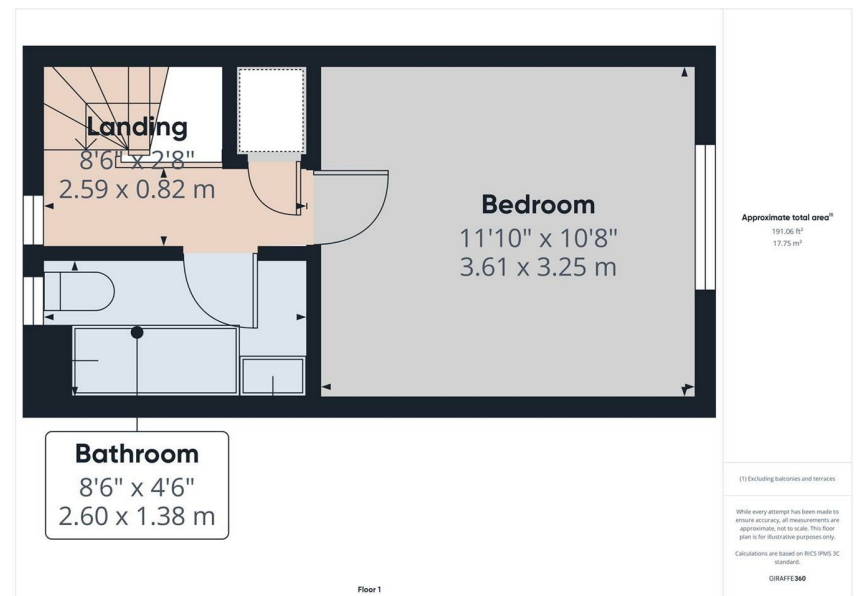



167 - 169 Church Road, Yardley, Birmingham, B25 8UR  
[yardley@primestatesuk.com](mailto:yardley@primestatesuk.com)